

SELF-CLOSING HINGES FOR DOORS AND GATES

 FT 780 0304
 Rév. 1 0806

GENERAL

SUPER VENUS, VENUS, SUPER SALOON®, SALOON®, ISODOUCHE® and Minidouche form a complete line of ADLER® self-closing hinges for swing doors and gates, shower screens, etc ...

The cam and piston mechanisms (patented by ADLER S.A.) make them both very rugged and perfectly silent. Self-closing to at least one balanced position without jamming is ensured. The door moves smoothly and returns normally to the specified position. With a clean line and irreproachable finish, these hinges blend discreetly into all interior designs where styling is just as important as technique. ADLER® self-closing hinges are easy to install, generally by a single person, by their counterleaf clamping system.

Comparative table of ADLER® self-closing hinges technical specifications :

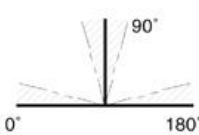
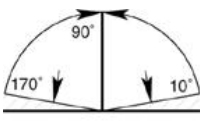
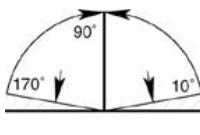
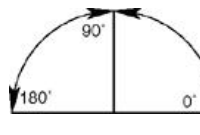
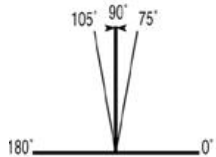
SPECIFICATIONS		VENUS SUPER VENUS	SUPER SALOON®	SALOON®A	SALOON®SA	ISODOUCHE® MINIDOUCHE	
FUNCTION							
Stop zone		Three ±10° return zones: 0°, 90° and 180°. Stopping in all other positions	Two ±10° stop zones : 0° and 180°. Return to 90° in all other positions.	Two ±10° stop zones : 0° and 180°. Return to 90° in all other positions.	Return to 90° in all positions	Stopping in all positions except in the 75°/105° zone with self-closure to 90°	
Door	HxW (cm)	180 X 70 (VENUS) 200 X 100 (SUPER VENUS)	210 X 100	Saloon (A and SA) "45" : 190 x 95 Depending on model : 190 x 95 or 180 x 70 Saloon (A and SA) and Isidouche			
	Dimensions	Th. (mm)*	6 or 8 (VENUS) 8 or 10 (SUPER VENUS)	10	8 to 10		
	Max. load (per pair)	25 (VENUS) 50 (SUPER VENUS)	52	31 or 45 (SALOON, ISODOUCHE) 31 (MINIDOUCHE)			
Number of versions		5 (VENUS) 2 (SUPER VENUS)	1	2		5 (ISODOUCHE) 4 (MINIDOUCHE)	
Material		brass	aluminium	brass		brass	
Finish		chrome nacre gold white (RAL 9010) --	chrome brushed, natural colour anodized gold anodized white (RAL 9010) polished, bright anodized	chrome matt chrome gold -- --	chrome matt chrome gold -- --	chrome matt chrome gold (ISODOUCHE only) brushed, chrome white (RAL 9010)	

* For other dimension please consult the "calculation" page on our web-site : www.adler-sa.fr

VENUS

APPLICATIONS

VENUS hinges are designed for doors and gates whose thickness does not exceed 6 mm (VENUS 6) or 8 mm (VENUS). They ensure return to 0°, 90° and 180° in a $\pm 10^\circ$ zone and stopping in all other positions. The VENUS line combines a very modern design (patented model) with a completely original mechanism (patented by ADLER S.A). The slightly domed leaves and rounded edges catch the eye discreetly. A single corrosion-proof and practically wear-proof part performs the function traditionally provided by pistons and springs, thereby eliminating any risk of jamming. They combine ruggedness and simplicity:

- The plate and came are made of one piece as is the bracket plate
- The 6 mm hinge pin and screws are made of stainless steel.

The VENUS line includes 5 hinge models :

- Wall leaf (1)
- 180° glass/glass (2)
- 90° glass/glass (3)
- Offset glass/glass, rotation through 180° (4)
- 135° glass/glass (5)

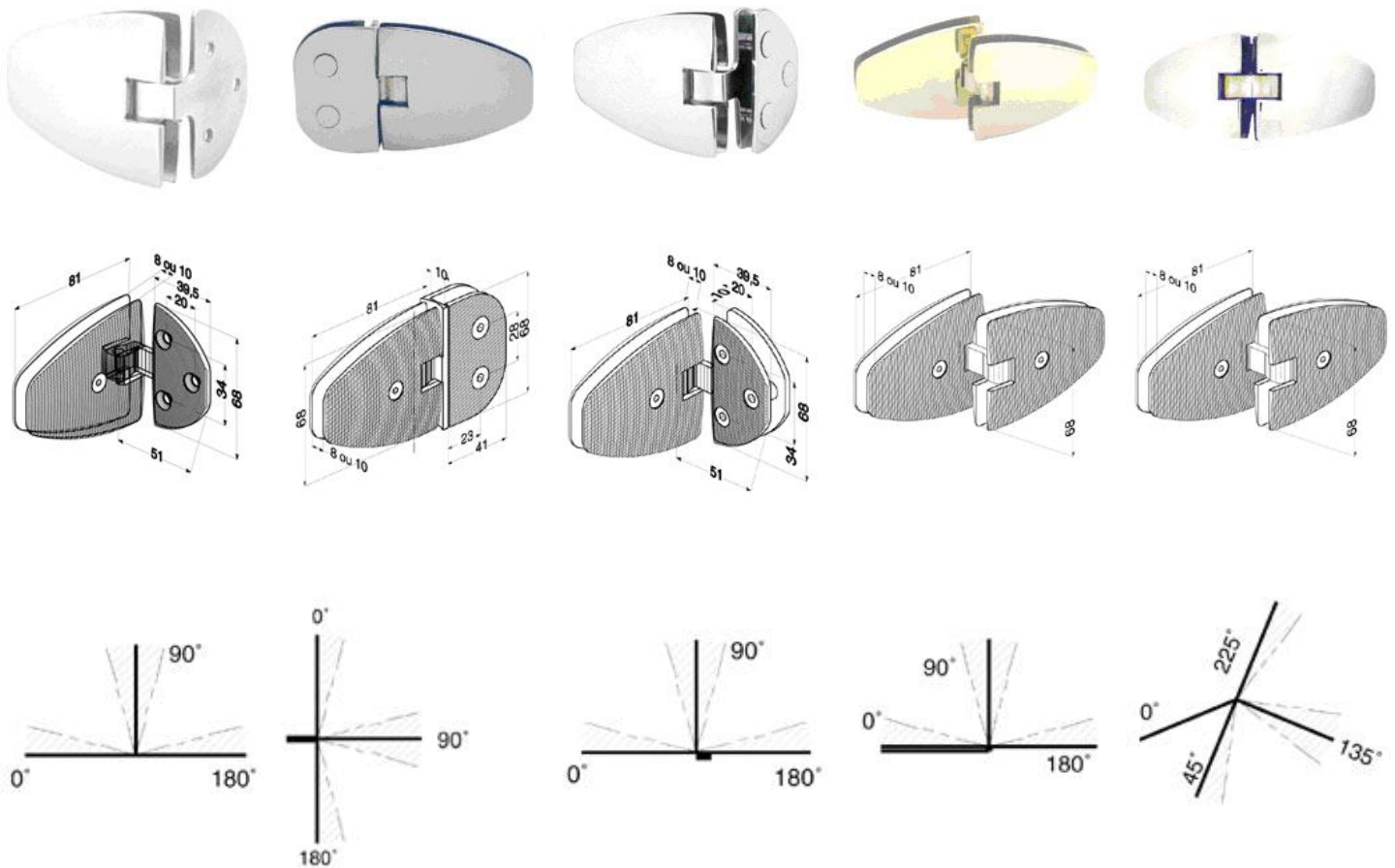

VENUS (cont'd)

ASSEMBLING

- DOOR : - Height x width = 1,8m x 0,7 m
 - Thickness : 6 or 8 mm, depending on the hinge model
 - Load : 25 kg (maximum)
 - Notches : see next page

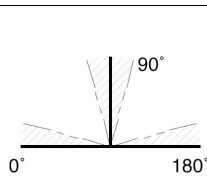
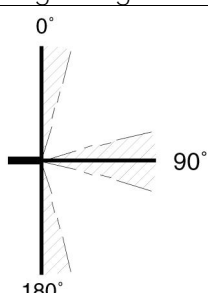
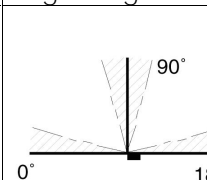
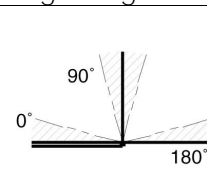
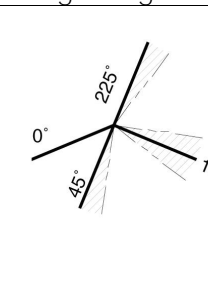
SPECIFICATIONS	Wall leaf	180° glass/glass	90° glass/glass	Offset glass/glass	135° glass/glass
INSTALLATION					
NOTCH ON FIXED LEAF	-	B	C	A	A
NOTCH ON OPENING LEAF	A	A	A	A	A
SPACING FROM THE SUPPORT	2,5	3,5	2,5	Distance between centre 22 mm	Distance between centre 28mm

FINISH - DECOR

VENUS 6 and VENUS hinges are made of brass. The standard line is available with four finishes : bright chrome, naced, gold, and white (RAL 9010). Other finishes are possible. Consult ADLER S.A. for quantities and delay.

ACCESSORIES

The accessories for use with doors and gates are included in the ADLER S.A. catalogue, e.g. :

- Pull knobs, see family 699
- Seals, see family 790
- stops, see family 799

VENUS (Cont'd)



699



790



NOTCHES

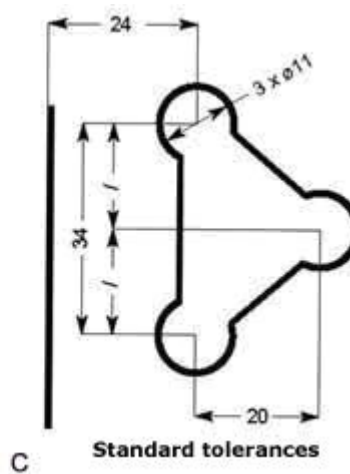
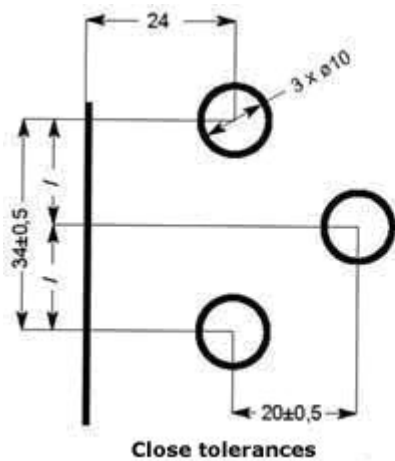
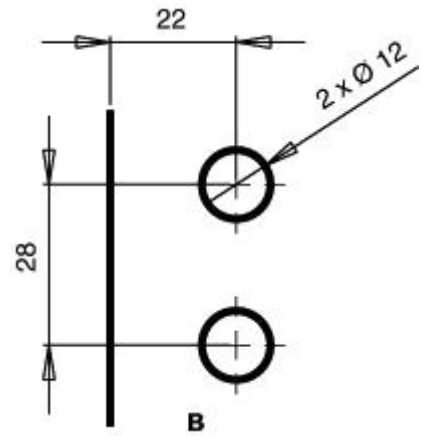
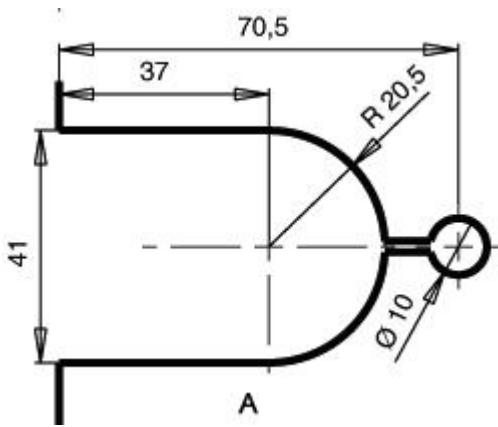

VENUS (cont'd)

PARTS LIST

DESCRIPTION	PART NUMBER		SOLD BY
	6 mm GLASS	8 mm GLASS	
VENUS hinges with wall leaf - Chrome - Nacre - Gold - White (RAL 9010)	648 60A	648 80X	SET OF 2
	648 61B	648 81Y	"
	648 54U	648 56W	"
	648 63D	648 83A	"
VENUS 180° glass/glass hinges - Chrome - Nacre - Gold - White (RAL 9010)	648 65G	648 85C	"
	648 66H	648 86D	"
	648 57X	648 58Y	"
	648 68K	648 88G	"
VENUS 90° glass/glass hinges - Chrome - Nacre - Gold - White (RAL 9010)	648 70M	648 90J	"
	648 71N	648 91K	"
	648 59Z	648 64F	"
	648 73Q	648 93M	"
VENUS offset glass/glass hinges - Chrome - Nacre - Gold - White (RAL 9010)	648 75S	648 95P	"
	648 76T	648 96Q	"
	648 69L	648 97R	"
	648 78V	648 98S	"
VENUS 135° glass/glass hinges - Chrome - Nacre - Gold - White (RAL 9010)	----	648 01M	"
	----	648 20H	"
	----	648 79W	"
	----	648 23L	"
Lip seal - Translucent PVC section	790 01W	790 02X	Lg 2,10m
Magnetic PVC weather strip - magnetic seal 90° - North - magnetic seal 90° - South - magnetic seal 180°	790 03Y		Lg 2,20m
	790 04Z		"
	790 05A		"
ADLER® single brass knob to be glued - Chrome - Matt chrome - Polished	699 65Z		Unit
	699 71G		"
	699 66A		"
ADLER® single brass knob to be screwed - Chrome - Matt chrome - Polished - White	699 67B		Unit
	699 73J		"
	699 68C		"
	699 72H		"
ADLER® double brass knob - Chrome - Matt chrome - Polished - White	699 69D		"
	699 75L		"
	699 70F		"
	699 74X		"

SUPER SALOON[®]

APPLICATION

SUPER SALOON[®] hinges are designed for interior swing doors 10 mm thick, especially made of glass.

They ensure :

- Automatic return to the 90° balanced position
- Stopping in the 0° and 180° open positions in a $\pm 10^\circ$ zone.

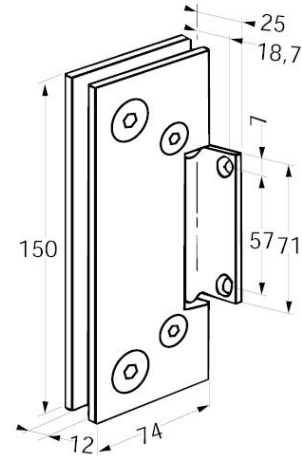
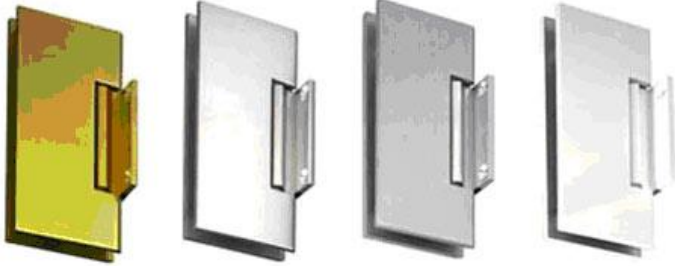

ASSEMBLING

DOOR :

- Height x width = 2.10 m x 1.00 (maximum)
- Thickness : 10 mm
- Load : 52 kg (maximum)
- Notch : see opposite

SPACING FROM THE SUPPORT :

- With a normal notch : 4 mm
- With a deep notch : 2 mm

ASSEMBLING

- . Remove the leaves and counterleaves and attach the SUPER SALOON[®] hinges flat on the door jamb, making sure they are aligned.
- . Check for the presence of the cork gaskets and install the leaves and counterleaves on the door.
- . Slide the clamps onto the cams attached to the door jamb.
- . Level and straighten the door.
- . Tighten the screws completely (use 4 mm and 5 mm Allen wrenches; recommended torque : 0.35 m.kg for M6 screws and 0.90 m.kg for M8 screws)
- (After screwing the plates to the door jamb, it is also possible to attach the counterleaves to them. Then install the door and leaves).
- Make sure there is no risk of opening the door more than 90° beyond the balanced position. If there is, provide a stop.

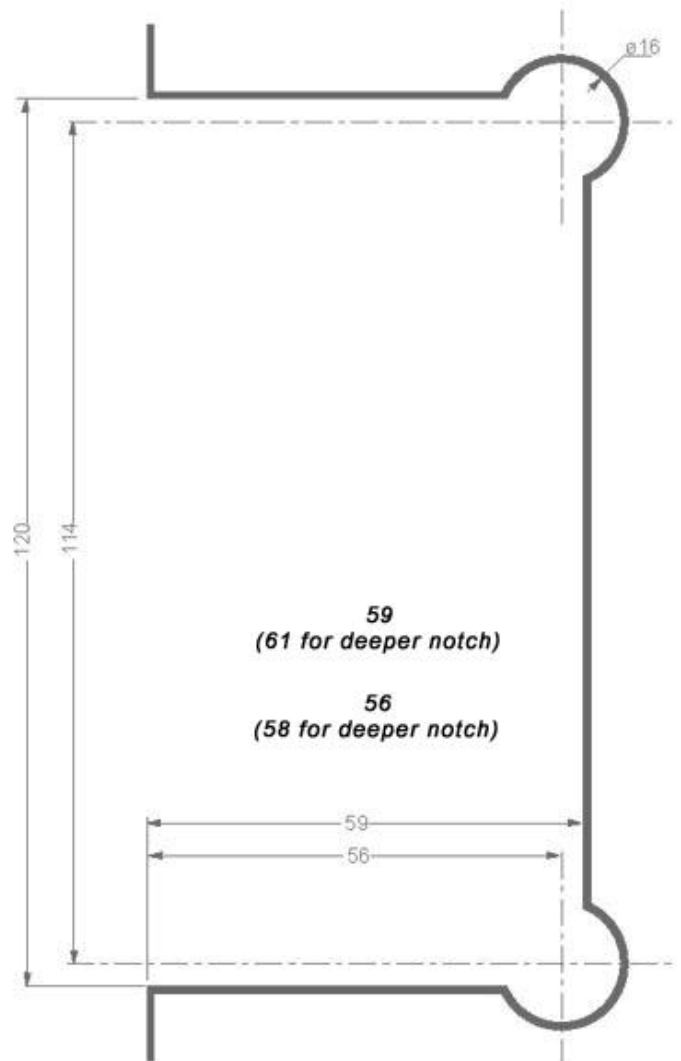

FINISH - DECOR

SUPER SALOON[®] hinges are made of aluminium and are available in five finishes : natural brushed anodized, white epoxy (RAL 9010), gold anodized, bright polished anodized and chrome. The hardware is made of stainless steel.

ACCESSORIES



- . The door may be fitted with a handle. It is recommended to use :
 - ADLER[®] crystal handles (hole diameter : 14 mm), family 704
 - ADLER[®] "cup" handles made of anodized light alloy (hole diameter : 16 mm), family 708
- . Stops : see family 799 of the general ADLER S.A. catalogue.

PARTS LIST

PART NUMBER	DESCRIPTION	SOLD BY
648 27Q	SUPER SALOON [®] - hinge - Brushed natural anodized	Set of 2
648 28R	SUPER SALOON [®] - hinge - White epoxy (RAL 9010)	Set of 2
648 29S	SUPER SALOON [®] - hinge - Gold anodized	Set of 2
648 30T	SUPER SALOON [®] - hinge - Bright polished anodized	Set of 2
648 31U	SUPER SALOON [®] - hinge - Chrome	Set of 2
704 01Y	"Crystal ball" handle, dia.50 mm - Chrome-plated brass pin	Set of 2
704 02Z	"Crystal ball" handle, dia.50 mm - Polished brass pin	Set of 2
704 03A	"Crystal ball" handle, dia.60 mm - Chrome-plated brass pin	Set of 2
704 04B	"Crystal ball" handle, dia.60 mm - Polished brass pin	Set of 2
704 05C	"Crystal ball" handle, dia.70 mm - Chrome-plated brass pin	Set of 2
704 06D	"Crystal ball" handle, dia.70 mm - Polished brass pin	Set of 2
704 11k	"Crystal half-ball" handle, dia.50 mm - Chrome-plated brass pin	Set of 2
704 12L	"Crystal half-ball" handle, dia.50 mm - Polished brass pin	Set of 2
704 13M	"Crystal half-ball" handle, dia.60 mm - Chrome-plated brass pin	Set of 2
704 14N	"Crystal half-ball" handle, dia.60 mm - Polished brass pin	Set of 2
704 15P	"Crystal half-ball" handle, dia.70 mm - Chrome-plated brass pin	Set of 2
704 16Q	"Crystal half-ball" handle, dia.70 mm - Polished brass pin	Set of 2
708 18B	Light alloy cup handle - dia. 115 mm - Natural	Set of 2
708 19C	Light alloy cup handle - dia. 115 mm - Gold anodized	Set of 2
708 20D	Light alloy cup handle - dia. 142mm - Natural	Set of 2
708 21F	Light alloy cup handle - dia. 142 mm - Gold anodized	Set of 2

SALOON[®]A and saLOON[®]SA

APPLICATIONS

SALOON[®]A and saLOON[®]SA hinges are designed for swing doors 8 to 10 mm thick, especially made of glass. They ensure a return to the balanced position (90°)

- In all positions for version SA ,
- Except outside a $\pm 10^\circ$ zone before each stop position (0° and 180°) for version A

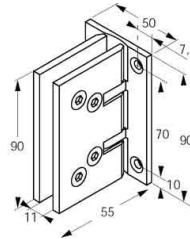
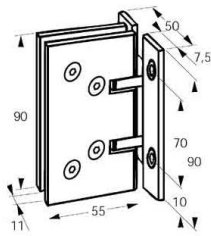

Version "45" differs from the traditional version by the heavy-duty 4 mm thick wall plate.

ASSEMBLING

Door :

- . Height x width : 180 cm x 70 cm or 190 cm x 95 cm for version " 45".
- . Thickness : 8 to 10 mm
- . Maximum load : 31 kg/pair or 45 kg/pair for version " 45"
- . Notch : normal or deep in normal version; only deep in version " 45"

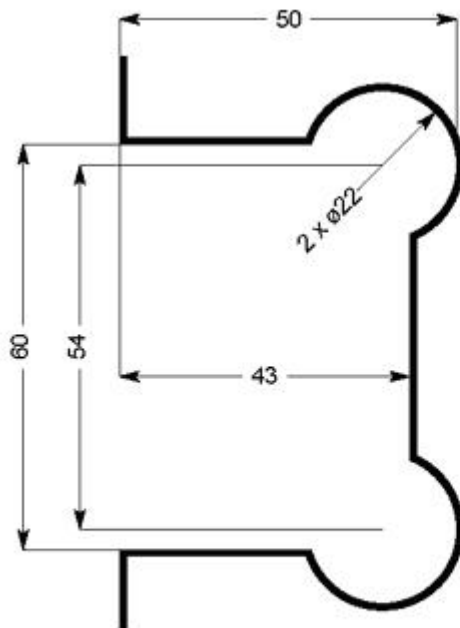

Normal notch, separation from support 6 mm

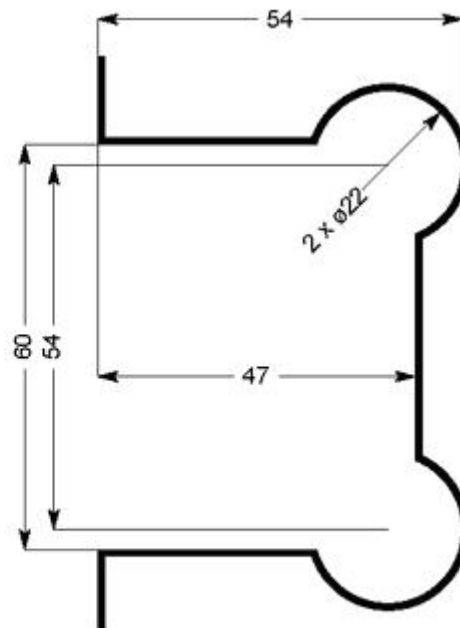

Deep notch, separation from support 2 mm

Separation from support :

- . With normal notch : 6 mm (normal version)
- . With deep notch : 2 mm (normal version and " 45").

Nota : In standard model the wall plate has cut-outs in bottom and top parts, PVC sealing strips (790 02X, 790 06B) or tubular seal (790 08D) can be extended to the hinge's inside. It is not the case with "45" model. In order to achieve some water tightness it is recommended to use a deeper cut out for the hinge which offers minimum space between glass and wall.

INSTALLATION

- . Remove the leaves and counterleaves and attach the SALOON® hinges flat on the doorjamb, making sure they are aligned.
- . Check for the presence of the cork gaskets and install the leaves and counterleaves on the door.
- . Slide the clamps onto the cams attached to the doorjamb. Level and straighten the door.
- . Tighten the screws completely (use an Allen wrench). Recommended torque : 0,25 m.Kg
- . In case of an offset, compensation plates are available (thickness 3mm).
- . Make sure there is no risk of opening the door more than 90° beyond the balanced position. If there is, provide a stop.

FINISH - DECOR

SALOON® hinges are made of brass and are normally available in three finishes : chrome, matt chrome and gold.

ACCESSORIES

The accessories for use with doors and gates are included in the ADLER S.A. catalogue, e.g.:

- Pull knobs, see family 699
- Stops, see family 799
- Wipes and door seals, see family 790

PARTS LIST

PART NUMBER	DESCRIPTION	SOLD BY
648 22K	SALOON® A hinge - Chrome-plated brass	Set of 2
648 24M	SALOON® A hinge - Matt chrome-plated brass	Set of 2
648 25N	SALOON® A hinge - Gold brass	Set of 2
648 10W	SALOON® A 45 hinge - Chrome-plated brass	Set of 2
648 11X	SALOON® A 45 hinge - Matt chrome-plated brass	Set of 2
648 33W	SALOON® A 45 hinge - Gold brass	Set of 2
648 12Y	SALOON® SA hinge - Chrome-plated brass	Set of 2
648 14A	SALOON® SA hinge - Matt chrome-plated brass	Set of 2
648 32V	SALOON® SA hinge - Gold brass	Set of 2
648 15B	SALOON® SA 45 hinge - Chrome-plated brass	Set of 2
648 17D	SALOON® SA 45 hinge - Matt chrome-plated brass	Set of 2
648 47M	SALOON® SA 45 hinge - gold brass	Set of 2
648 34X	Compensation plate - Chrome-plated brass	Unit
648 35Y	Compensation plate - Polished brass	Unit
790 02X	Translucent PVC section for 8 mm glass thickness	Lg 2,20 m
790 06B	Translucent PVC section for 10 mm glass thickness	"
699 65Z	ADLER® raising button, to be glued :	unit
699 71G	- Chrome	"
699 66A	- Matt chrome	"
	- Polished	"
699 67B	ADLER® raising button, single, to be screwed :	unit
699 73J	- Chrome	"
699 68C	- Matt Chrome	"
699 72H	- Polished	"
	- white	"
699 69D	ADLER® raising button double :	unit
699 75L	- Chrome	"
699 70F	- Matt chrome	"
699 74X	- Polished	"
	- white	"

ISODOUCHE®

APPLICATIONS

ISODOUCHE® hinges are designed for doors 8 or 10 mm thick, especially made of glass. They hold the door firmly without jamming in all positions except a 15° zone on either side of the balanced self-closing position (90°).

ISODOUCHE® hinges are mainly used in bathrooms, shower stalls and separation gates.

DESCRIPTION

The ISODOUCHE® line includes five hinge models :

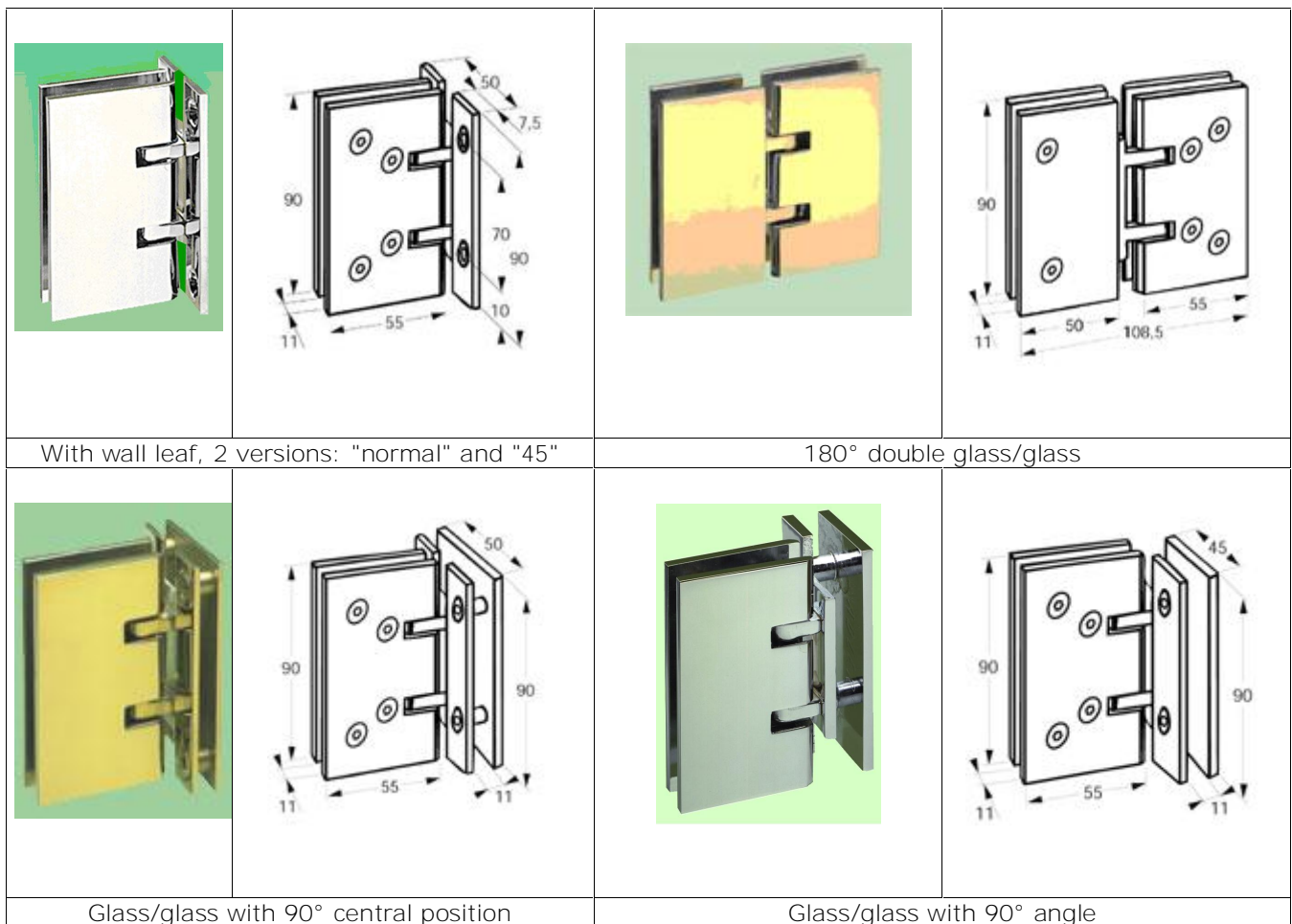

ASSEMBLING

Door :

- . Height x width : 180 cm x 70 cm or 190 cm x 95 cm for version "45".
- . Thickness : 8 to 10 mm
- . Maximum load : 31 kg/pair or 45 kg/pair for version "45".
- . Notch normal or deep in normal version; only deep in version "45"

Nota : In standard model the wall plate has cut-outs in bottom and top parts, PVC sealing strips (790 02X, 790 06B) or tubular seal (790 08D) can be extended to the hinge's inside. It is not the case with "45" model. In order to achieve some water tightness it is recommended to use a deeper cut out for the hinge which offers minimum space between glass and wall.

Separation from the support :

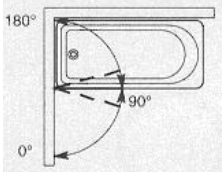
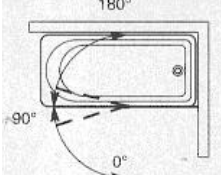
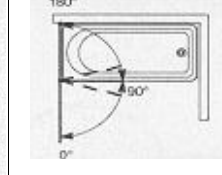
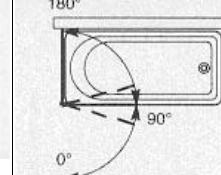
SPECIFICATIONS		With wall leaf	180° double glass/glass	Glass/glass Central 90° position	Glass/glass with 90° angle
INSTALLATION					
NOTCH ON FIXED PANEL		-	- A - (2x notch)	- B -	- C -
Notch on opening panel	Normal notch (4x) Separation from the support	- D - 6 mm	- D - 6 mm	- D - 6 mm	-
	Deep Notch Separation from the support	- E - 2 mm	- E - 2 mm	- E - 2 mm	- F - 3 mm

INSTALLATION

- . Remove the leaves and counterleaves and attach the Isodouche® hinges flat on the doorjamb, making sure they are aligned.
- . Check for the presence of the cork gaskets and install the leaves and counterleaves on the door.
- . Slide the clamps onto the cams attached to the doorjamb. Level and straighten the door.
- . Tighten the screws completely (use an Allen wrench). Recommended torque : 0,25 m.Kg
- . In case of an offset, compensation plates are available (thickness 3mm).
- . Make sure there is no risk of opening the door more than 90° beyond the balanced position. If there is, provide a stop.

FINISH - DECOR

ISODOUCHE® hinges are available with three finishes : Chrome-plated brass, matt chrome and gold brass. The model with wall leaf is also available with a white epoxy (RAL 9010) or brushed chrome finish.

ACCESSORIES

The ADLER S.A. catalogue includes many accessories for use in separations, shower stalls and bathrooms, e.g.

- Shower curtain rod, pull knob, see family 699
- Clamps for attachment of separations, see families 504 and 634
- Water deflector, see family 790

ISODOUCHE[®] (cont'd)

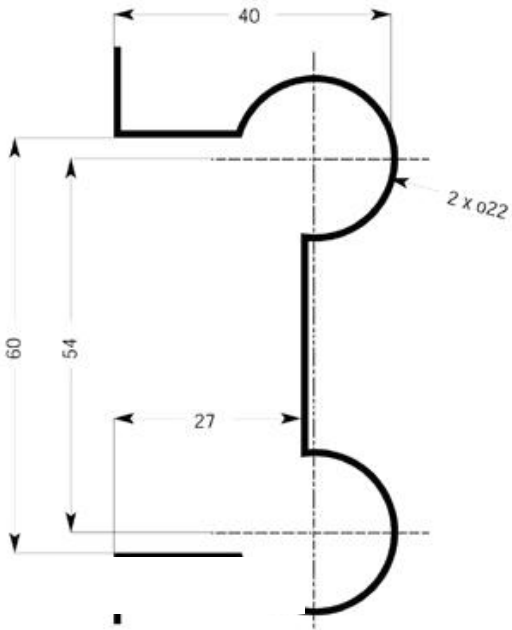

on the opening panel, notch D or E

A

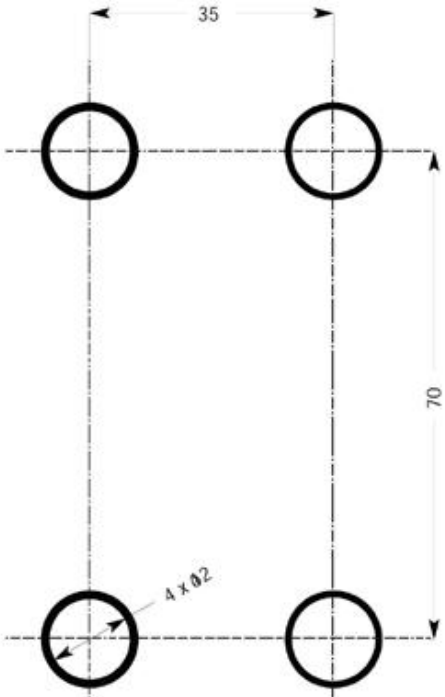

on the opening panel, notch D or E

B

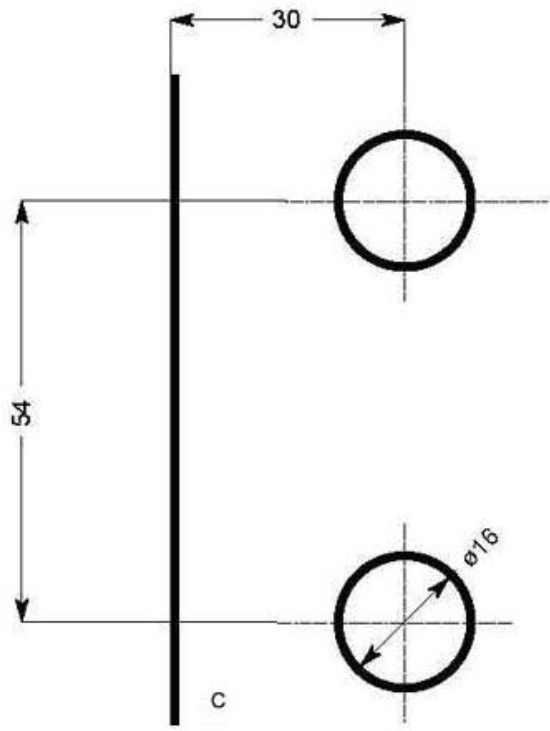

C

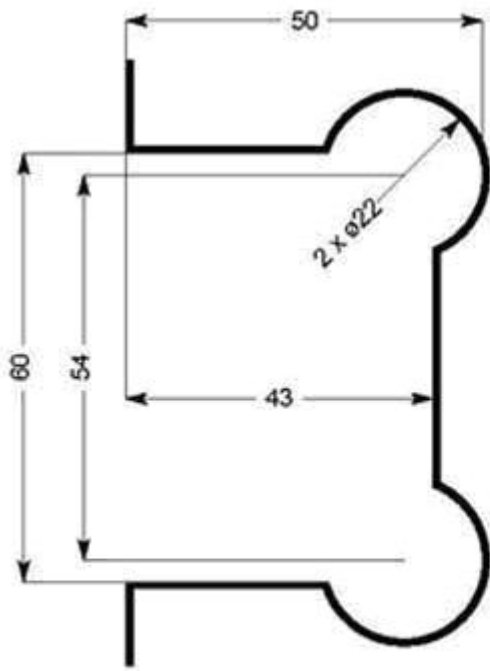

Normal notch
D

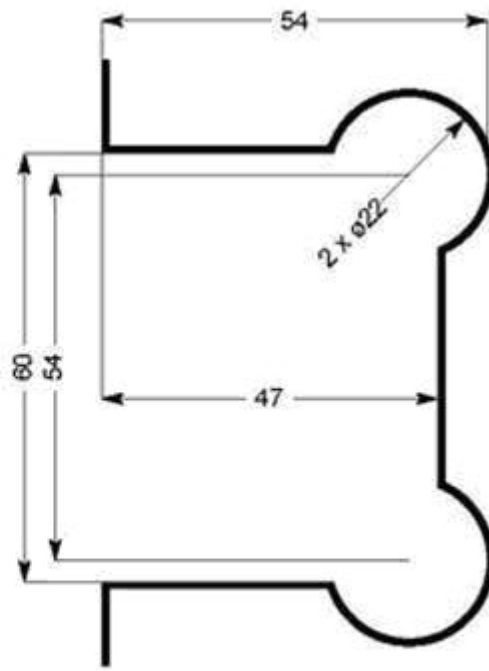

Deep notch
E

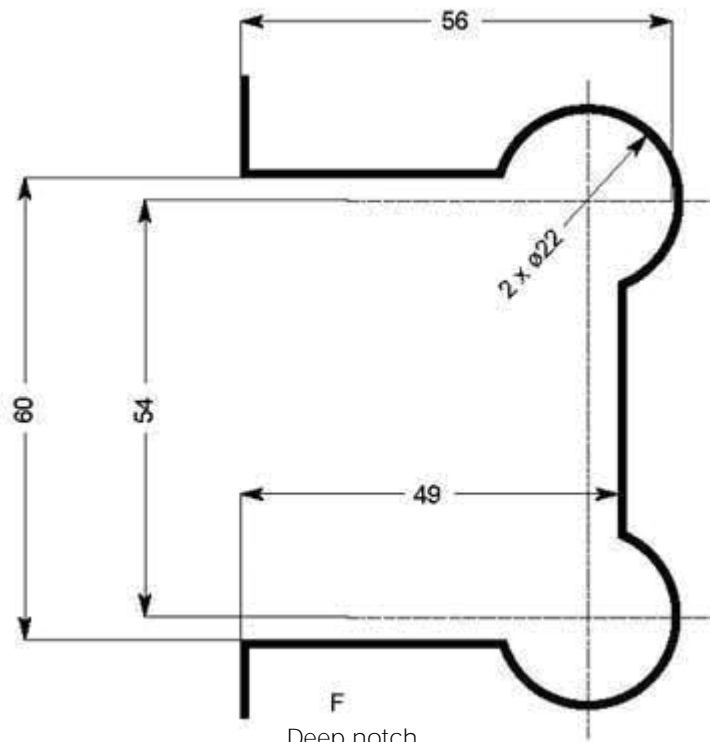

F
Deep notch

ISODOUCHE[®] (cont'd)

PARTS LIST

PART NUMBER	DESCRIPTION	SOLD BY
648 02N	ISODOUCHE [®] hinge with wall leaf - Chrome-plated	Set of 2
648 03P	ISODOUCHE [®] hinge with wall leaf - Brushed chrome	Set of 2
648 04Q	ISODOUCHE [®] hinge with wall leaf - Matt chrome	Set of 2
648 00L	ISODOUCHE [®] hinge with wall leaf - Gold brass	Set of 2
648 45K	ISODOUCHE [®] hinge with wall leaf - White epoxy (RAL 9010)	Set of 2
648 05R	ISODOUCHE [®] "45" hinge with wall leaf - Chrome-plated	Set of 2
648 07T	ISODOUCHE [®] "45" hinge with wall leaf - Matt chrome	Set of 2
648 19G	ISODOUCHE [®] "45" hinge with wall leaf - Gold brass	Set of 2
648 09V	ISODOUCHE [®] "45" hinge with wall leaf - Brushed chromed	Set of 2
648 36Z	ISODOUCHE [®] 180° glass/glass hinge - Chrome	Set of 2
648 37A	ISODOUCHE [®] 180° glass/glass hinge - Matt chrome	Set of 2
648 48N	ISODOUCHE [®] 180° glass/glass hinge - Gold brass	Set of 2
648 46L	ISODOUCHE [®] 180° glass/glass hinge - white epoxy (RAL 9010)	Set of 2
648 42G	ISODOUCHE [®] glass/glass hinge with central 90° position - Chrome	Set of 2
648 43H	ISODOUCHE [®] glass/glass hinge with central 90° position - Matt chrome	Set of 2
648 53T	ISODOUCHE [®] glass/glass hinge with central 90° position - Gold brass	Set of 2
648 39C	ISODOUCHE [®] glass/glass hinge with 90° angle - Chrome	Set of 2
648 40D	ISODOUCHE [®] glass/glass hinge with 90° angle - Matt chrome	Set of 2
648 49P	ISODOUCHE [®] glass/glass hinge with 90° angle - Gold brass	Set of 2
648 34X	Compensation plate (th. 3 mm) - Chrome	Unit
648 35Y	compensation plate (th. 3 mm) - Gold	Unit

ISODOUCHE[®] (cont'd)

PART NUMBER	DESCRIPTION	SOLD BY
790 02X 790 06B	Translucent PVC section for 8 mm glass thickness Translucent PVC section for 10 mm glass thickness	Lg 2,20 m "
699 65Z 699 71G 699 66A	ADLER [®] raising button, to be glued : - Chrome - Matt chrome - Polished	unit " "
699 67B 699 73J 699 68C 699 72H	ADLER [®] raising button, single, to be screwed : - Chrome - Matt Chrome - Polished - white	unit " " "
699 69D 699 75L 699 70F 699 74X	ADLER [®] raising button double : - Chrome - Matt chrome - Polished - white	unit " " "



Z.A la barogne, avenue des 22 Arpents – 77230 MOUSSY LE NEUF
 Tel.: (33)1.60.03.62.00 Fax.: (33)1.60.03.62.49
 E-mail : commercial@adler-sa.com web site : www.adler-sa.fr